

# CF 810 Crack & Joint Pro

## Insulating Filler Foam

### Product Description

CF 810 Crack and Joint Pro is a high performance, high yield polyurethane foam for filling around penetrations and general gap/crack applications. This product is ideal for reducing air, sound, dirt, and water infiltration. CF 810 complies with ASTM C 1620, the industry's first specification on aerosol foam sealants.

### Applications For Use

- Pipe / cable penetrations
- Blank opening gaps / cracks
- HVAC ducts
- Electrical junction boxes
- Head of wall joints
- Base plate cracks
- Concrete formwork voids
- Metal decking seams
- General insulating

### Technical Data

<b>Foam Yield per Can:</b>	Approx 1.55ft <sup>3</sup>
<b>Approximate Cure Schedule:</b> (ASTM C 1620)	Tack free after approx 8-10 minutes Ready to cut after approx 10-15 minutes
<b>Application Temperature:</b>	41°F to 95°F (5°C to 35°C)
<b>Air Infiltration:</b> (ASTM E 283)	< 0.01 cfm/ft <sup>2</sup> @ 1.56 psf (75Pa)
<b>Water Infiltration:</b> (ASTM E 331)	No Leakage after 15 minute exposure (@ 2.9 psf)
<b>Sound Transmission Classification:</b> (as tested per ASTM E 90)	55
<b>Dimensional Stability:</b> (AAMA 812)	+/- 4%
<b>Tensile Strength:</b> (HTC Method 2106)	> 6 N/cm <sup>2</sup>
<b>R-Value:</b> (ASTM C 518)	5.24
<b>Surface Burning Characteristics:</b> (UL 723)	Flame Spread: 0 Smoke Developed: 5
<b>Shelf Life from Date of Manufacture:</b> (when stored at 68°F)	12 months

## Installation Instructions

---

Mount dispenser on can with the can on a flat surface. Do not over tighten. Shake can vigorously after attaching the dispenser.

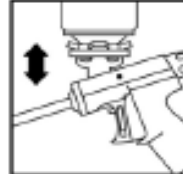

Open valve to allow foam to fill dispenser. Unlock the safety on the trigger to allow foam dispensing. Point away and pull trigger to dispense foam.

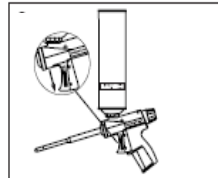
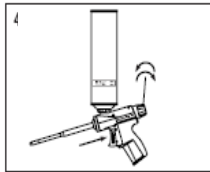

Caution:

- Read MSDS, product data sheet, and label on can prior to use.
- Wear protective gloves and eyewear.
- Shut off all pilot lights and other sources of ignition.
- Do not smoke when using this product.

## Ordering Information

---

### Foam

<u>Item No.</u>	<u>Description</u>	<u>Qty.</u>
227974	CF 810 Foam (23 oz can)	1
3413888	CF 810 Foam (case of 12 cans)	12

### Dispensers

<u>Item No.</u>	<u>Description</u>	<u>Qty.</u>
259768	CF-DS1 Dispenser	1
313187	P20-600K Extra Long Dispenser (with 27" barrel)	1
311512	Plastic Nozzle Tip	20

### Cleaner

<u>Item No.</u>	<u>Description</u>	<u>Qty.</u>
24631	CF-R1 Cleaner (17 oz can)	1