

CF 812 Window & Door Pro

Low Pressure Filler Foam

Product Description

CF 812 Window and Door Pro is a low pressure polyurethane foam for use around the perimeter openings of window and door frames (tested in accordance with AAMA 812). This product is ideal for reducing air, sound, dirt, and water infiltration. CF 812 complies with ASTM C 1620, the industry's first specification on aerosol foam sealants.

Applications For Use

- Window and door frame openings
- Skylights
- General insulating



CF 812 Technical Data

Foam Yield per Can:	Approx 1.30ft ³
Approximate Cure Schedule:	Tack free after approx 8-10 minutes Ready to cut after approx 15-20 minutes
Application Temperature:	41°F to 95°F (5°C to 35°C)
Air Infiltration: (ASTM E 283)	< 0.01 cfm/ft ² @ 1.56 psf (75 Pa)
Water Infiltration: (ASTM E 331)	No Leakage after 15 minute exposure (@ 2.9 psf)
Sound Transmission Classification: (as tested per ASTM E 90)	55
Pressure Build Average: (AAMA 812)	0.79 psi (5.4 kPa)
Dimensional Stability: (AAMA 812)	+/- 2%
Tensile Strength: (HTC Method 2106)	> 6 N/cm ²
R-Value: (ASTM C 518)	4.27
Surface Burning Characteristics: (UL 723)	Flame Spread: 0 Smoke Developed: 5
Shelf Life from Date of Manufacture: (when stored at 68°F)	12 months

Installation Instructions

Mount dispenser on can with the can on a flat surface. Do not over tighten. Shake can vigorously after attaching the dispenser.

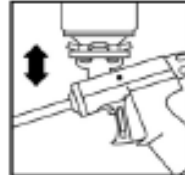

Open valve to allow foam to fill dispenser. Unlock the safety on the trigger to allow foam dispensing. Point away and pull trigger to dispense foam. Do not fill rough opening gaps around windows and doors more than 50% to allow for expansion and maximize curing.

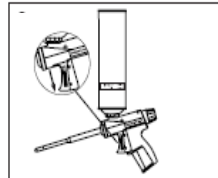
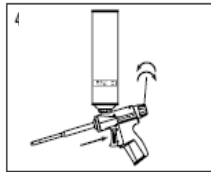

Caution:

- Hilti installation instructions shall not supersede the window and/or door manufacturer's instructions.
- Read MSDS, product data sheet, and label on can prior to use.
- Wear protective gloves and eyewear.
- Shut off all pilot lights and other sources of ignition.
- Do not smoke when using this product.

Ordering Information

Foam

<u>Item No.</u>	<u>Description</u>	<u>Qty.</u>
227975	CF 812 Foam (22.5 oz can)	1
3413889	CF 812 Foam (case of 12 cans)	12

Dispensers

<u>Item No.</u>	<u>Description</u>	<u>Qty.</u>
259768	CF-DS1 Dispenser	1
313187	P20-600K Extra Long Dispenser (with 27" barrel)	1
311512	Plastic Nozzle Tip	20

Cleaner

<u>Item No.</u>	<u>Description</u>	<u>Qty.</u>
24631	CF-R1 Cleaner (17 oz can)	1